

SA1 (EXIST.MH)

LEASE COUNTRY CLUB REM OF TOWNLANDS

REM OF TOWNLANDS

VICTORIA COUNTRY CLUB ESTATE - VILLAGE 1 ERF 9194 PIETERMARITZBURG

PROPOSED PORTION 1 OF ERF 3142

ERF 3142 (PROPOSED REM OF ERF 3142)

PETER BROWN DRIVE

NATIONAL ROAD

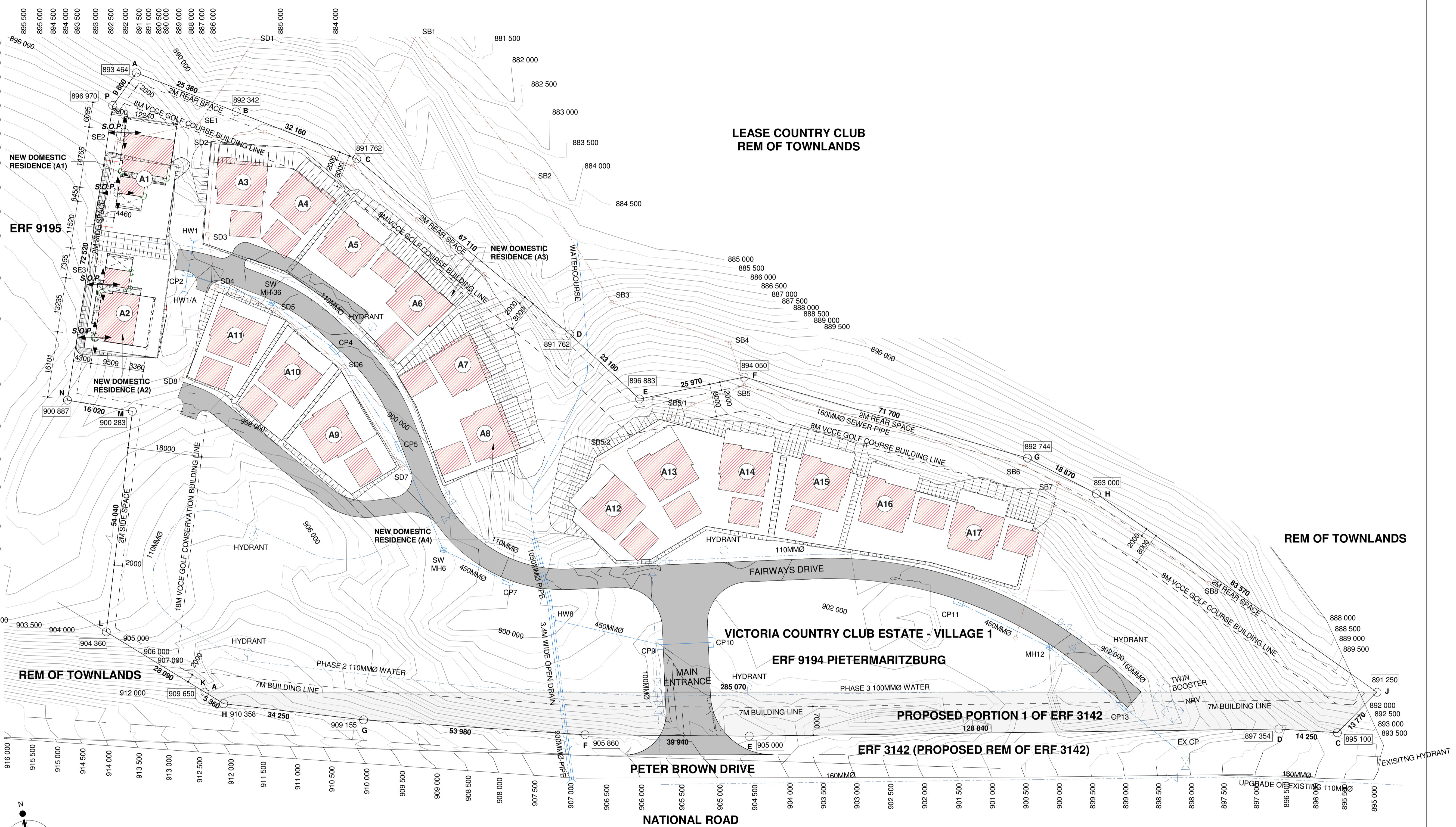

SITE PLAN
SCALE 1 : 500

PLOT DATE : 13-Nov-20
FILE PATH : G:\EPA PROJECTS\2020\20042 - RETIREMENT COTTAGES, PETER BROWN DRIVE, VCCE - PMB Drawings\Rev\Central File\TECHNICAL MODEL\20042-SITE\20042-VCCE-SITE MODEL.rvt
SHEET SIZE : A1

date	rev.	description	rev. by
	A	FOR MUNICIPAL SUBMISSION	PS

owner's signature: **NICK PROOME**
 architect's name: **SACAP 4218**
 architect's sacap no.:
 architect's signature:

COPYRIGHT NOTICE
Copyright © 2020 **Elphick Proome Architecture**
Copyright subsists in this drawing. The person or entity whose name appears in the title block of this drawing, is hereby granted a non-exclusive license to use, display, print and / or reproduce this drawing to the extent necessary to carry out and complete the project described in the title block of this drawing.
This license in respect of the copyright is expressly limited as aforesaid and the person and/or entity referred to above shall not be entitled to grant sub-licenses in respect of the copyright in this drawing to any other entity.
This license confers no ownership rights in the copyright vesting in the drawing and this drawing and the copyright subsisting therein will, at all times, remain the property of **Elphick Proome Architecture**.
Any unauthorized reproduction, publication, transmission, adaptation and/or inclusion of this drawing in a cinematograph film or television broadcast is an act of copyright infringement which will render the doer of the act liable for civil law copyright infringement and may in certain circumstances render the doer liable to criminal prosecution.
Requests and enquiries concerning this drawing and the rights subsisting therein should be addressed to the copyright owner.

ACTS OF PARLIAMENT
All Contractors shall ensure that, before any work is put in hand, they comply with all the necessary Acts of Parliament of the Republic of South Africa.

drawing legend

- all work to be done in accordance with National Building Regulations and Building Standards Act No. 103 of 1977
- figured dimensions to be taken in preference to scaled dimensions
- report any discrepancies direct to the architect before commencing work
- this drawing is copyright and remains with the architect

annotation legend

- W-1 wall type
- F4 wall finish
- H = 2600 headroom / ceiling height

standard hatch legend

- concrete
- clay brickwork
- concrete brickwork
- plaster
- earth

project no.
00000 - 0 - (0) - WG - 0000-000
EPA project number: 00000-0-0000-000
Phase: Phase 1
Category of drawing: Drawing No.

drawing categories
SK - Sketch Plans
LA - Drawings required for submission to Local Authority
WG - Working Drawings (base construction drawings) - scale 1:100
WL - Layout Drawings (Typically any drawing not a detail) - larger than 1:100
WD - Detail Drawings - all drawings 1:20 - 1:1
WS - Schedules (Doors, Windows, Shopfronts, Signage, etc.)

notes
the date reflected on the title block is the date of initial creation of the drawing and must not be altered. the revisions block will reflect the date of issue.

project PROPOSED NEW MEDIUM DENSITY HOUSING

location ERF 9194 PIETERMARITZBURG

client REIL ASSOCIATES (PTY) LIMITED

project no.
00000 - 0 - (0) - LA - 0100-001

drawing SITE PLAN

scale 1 : 500

date 21/10/2020

drawn PS

checked RP

revision A

epa

tel +27 31 275 5800
fax +27 31 275 5855

18 The Boulevard • Wesleyan office park
Wesleyan • Heidelberg • South Africa

elphick proome architects incorporated